

RS

Radial Lead Type
series

- Standard
- Low ESR, High ripple current
- Load life of 3,000h at 105°C

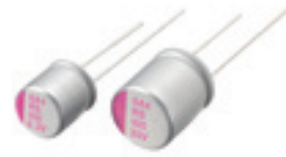

SPECIFICATIONS

Items	Characteristics	
Temperature range	-55 to +105°C	
Rated voltage range	2.5 to 25Vdc	
Capacitance range	6.8 to 1,500μF	
Capacitance tolerance	±20% [M] (at 20°C, 120Hz)	
Tangent of loss angle	Less than or equal to the value of Standard Ratings (at 20°C, 120Hz)	
Leakage current	Less than or equal to the value of Standard Ratings (at 20°C, after 2 minutes)	
ESR	Less than or equal to the value of Standard Ratings	
Characteristics of impedance	Z _{+105°C} /Z _{+20°C} ≤ 1.25, Z _{-55°C} /Z _{+20°C} ≤ 1.25 at 100kHz	
Endurance	105°C, 3,000 hrs at rated voltage	
	Appearance	No significant damage
	Capacitance change	Within±20% of the initial value
	Tangent of loss angle (tanδ)	≤150% of the initial specified value
	ESR(mΩ)	≤150% of the initial specified value
Damp Heat (Steady State)	60°C, 90 to 95% RH, 1,000 hrs, No-applied Voltage	
	Appearance	No significant damage
	Capacitance change	Within±20% of the initial value
	Tangent of loss angle (tanδ)	≤150% of the initial specified value
	ESR(mΩ)	≤150% of the initial specified value
Resistance to soldering heat	Flow method (260±5°C, 10s)	
	Appearance	No significant damage
	Capacitance change	Within±10% of the initial value
	Tangent of loss angle (tanδ)	≤130% of the initial specified value
	ESR(mΩ)	≤130% of the initial specified value
	Leakage current	
	≤The initial specified value	
	Leakage current	
	≤The initial specified value	
	Leakage current	
≤The initial specified value		

*In case of some problems for measured values, measure after applying rated voltage for 120 minutes at 105°C

SIZE LIST

(unit: mm)

μF	RV(sv) 2.5 (3.3)	4 (5.2)	6.3 (8.2)	10 (11.5)	16 (18.4)	20 (23.0)	25 (28.7)
6.8							6.3 x 6
10							8 x 7
22						6.3 x 6	10 x 8
33						8 x 7	8 x 11.5
39					6.3 x 6		
47					6.3 x 6	8 x 7	
56				6.3 x 6		10 x 8	10 x 11.5
68						10 x 8	
82			6.3 x 6		8 x 7		
100		6.3 x 6	6.3 x 6		8 x 7	10 x 8 8 x 11.5	8 x 11.5
120				8 x 7			
150		6.3 x 6	8 x 7	8 x 7	10 x 8	10 x 11.5	10 x 11.5
180					8 x 11.5		
220		8 x 7	8 x 7				
270				10 x 8			
330		8 x 7	10 x 8	8 x 11.5	10 x 11.5		
470		10 x 8	8 x 11.5		10 x 11.5		
560		8 x 11.5		10 x 11.5			
680	8 x 11.5	10 x 8					
820			10 x 11.5				
1000			10 x 11.5				
1200		10 x 11.5					
1500	10 x 11.5						

MARKING AND DIMENSIONS

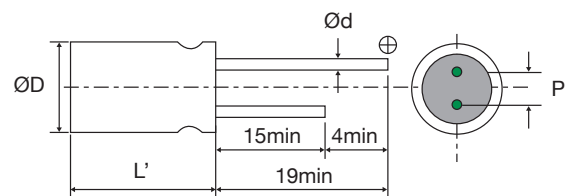

(unit: mm)

Size	∅D±0.5	L	L'	P±0.5	∅d
6.3 x 6	6.3	6.0		2.5	0.45
8 x 7	8.0	7.0	L max.	3.5	0.45
10 x 8	10.0	8.0		5.0	0.60
8 x 11.5	8.0	11.5	L+1.0max.	3.5	0.60
10 x 11.5	10.0	11.5		5.0	0.60

*RV : Rated Voltage [V] SV : Surge Voltage [V] (at room temperature)

Conductive Polymer Aluminum Capacitors

STANDARD RATINGS

Rated Voltage [Vdc]	Rated Capacitance [μF]	Size ΦD x L [mm]	ESR (20°C, 100kHz) [mΩ] [max.]	Rated Ripple Current (105°C, 100kHz) [mA _{RMS}]	Tangent of Loss Angel [max.]	Leakage Current [μA, max.]	Part Number
2.5	680	8 x 11.5	13	4520	0.10	340	2RS680MD11
	1500	10 x 11.5	13	5440	0.10	750	2RS1500ME11
4	100	6.3 x 6	40	1810	0.10	200	4RS100MC6
	150	6.3 x 6	40	1810	0.10	300	4RS150MC6
	220	8 x 7	35	2560	0.10	440	4RS220MD7
	330	8 x 7	35	2560	0.10	660	4RS330MD7
	470	10 x 8	25	3700	0.10	376	4RS470ME8
	560	8 x 11.5	13	4520	0.10	448	4RS560MD11
	680	10 x 8	25	3700	0.10	544	4RS680ME8
	1200	10 x 11.5	13	5440	0.10	960	4RS1200ME11
6.3	82	6.3 x 6	45	1700	0.10	258	6RS82MC6
	100	6.3 x 6	40	1810	0.10	315	6RS100MC6
	150	8 x 7	35	2560	0.10	472	6RS150MD7
	220	8 x 7	35	2560	0.10	693	6RS220MD7
	330	10 x 8	25	3700	0.10	416	6RS330ME8
	470	8 x 11.5	15	4210	0.10	592	6RS470MD11
	820	10 x 11.5	12	5440	0.10	1033	6RS820ME11
	1000	10 x 11.5	12	5440	0.10	1260	6RS1000ME11
10	56	6.3 x 6	45	1700	0.10	280	10RS56MC6
	120	8 x 7	35	2560	0.10	600	10RS120MD7
	150	8 x 7	35	2560	0.10	750	10RS150MD7
	270	10 x 8	25	3700	0.10	540	10RS270ME8
	330	8 x 11.5	17	3950	0.10	660	10RS330MD11
	560	10 x 11.5	13	5230	0.10	1120	10RS560ME11
	16	6.3 x 6	50	1620	0.10	312	16RS39MC6
16	47	6.3 x 6	50	1620	0.10	376	16RS47MC6
	82	8 x 7	40	2120	0.10	656	16RS82MD7
	100	8 x 7	40	2120	0.10	800	16RS100MD7
	150	10 x 8	30	3020	0.10	480	16RS150ME8
	180	8 x 11.5	20	3640	0.10	576	16RS180MD11
	330	10 x 11.5	16	4720	0.10	1056	16RS330ME11
	470	10 x 11.5	16	4720	0.10	1504	16RS470ME11
	20	22	6.3 x 6	60	1450	0.10	220
33		8 x 7	45	1890	0.10	330	20RS33MD7
47		8 x 7	45	1890	0.10	470	20RS47MD7
56		10 x 8	40	2400	0.10	224	20RS56ME8
68		10 x 8	40	2400	0.10	272	20RS68ME8
100		10 x 8	35	2570	0.10	400	20RS100ME8
100		8 x 11.5	24	3320	0.10	400	20RS100MD11
150		10 x 11.5	20	4320	0.10	600	20RS150ME11
25	6.8	6.3 x 6	80	1200	0.10	170	25RS6R8MC6
	10	8 x 7	60	1500	0.10	250	25RS10MD7
	22	10 x 8	50	2000	0.10	275	25RS22ME8
	33	8 x 11.5	30	2980	0.10	413	25RS33MD11
	56	10 x 11.5	28	3800	0.10	700	25RS56ME11
	100	8 x 11.5	30	3320	0.10	500	25RS100MD11
	150	10 x 11.5	25	4320	0.10	750	25RS150ME11

